

Sheraton Centre Toronto Hotel

123 Queen St W, Toronto, ON M5H 2M9

416-361-1000

<https://www.marriott.com/en-us/hotels/yyztc-sheraton-centre-toronto-hotel>

BUILDING ACCESS AND CONTACT

Entrances to the Building

Valet Entrance off Richmond St. at York St.

Queen St. entrance

Richmond St. entrance

From the parking lot under Nathan Phillips Square

From the PATH

Security Contact

Hotel Security - 416-361-1000 (Press "0", and ask for Security)



SIGN-IN PROTOCOL

There is no sign in protocol. Ask the front desk for assistance if you don't know where your room is.

EMERGENCY PLANS

IN CASE OF FIRE

UPON DISCOVERY OF FIRE

Leave fire area immediately.

Close doors.

Sound the fire alarm.

Pull the manual station.

Leave the building by the nearest exit.

**Call the FIRE DEPARTMENT
DIAL 911**

DO NOT USE ELEVATOR

UPON HEARING FIRE ALARM IF CONTINUOUS SIGNAL

Leave the building by the nearest exit.

Close doors behind you.

IF INTERMITTENT SIGNAL

Standby and prepare to leave building.

CAUTION

If smoke is heavy in the corridor, it may be safer to stay in your area. Close door and place wet towel at base of door. If you encounter smoke in stairway, use alternate exit.

REMAIN CALM

COMMON MUSTER POINT

The Toronto Sign in the middle of Nathan Phillips Square



NEAREST HOSPITALS

St. Michael's Hospital
36 Queen St E, Toronto, ON M5B 1W8
416-360-4000

LINKED BUILDINGS

The PATH
Nathan Phillips Square parking garage



FLOOR PLANS

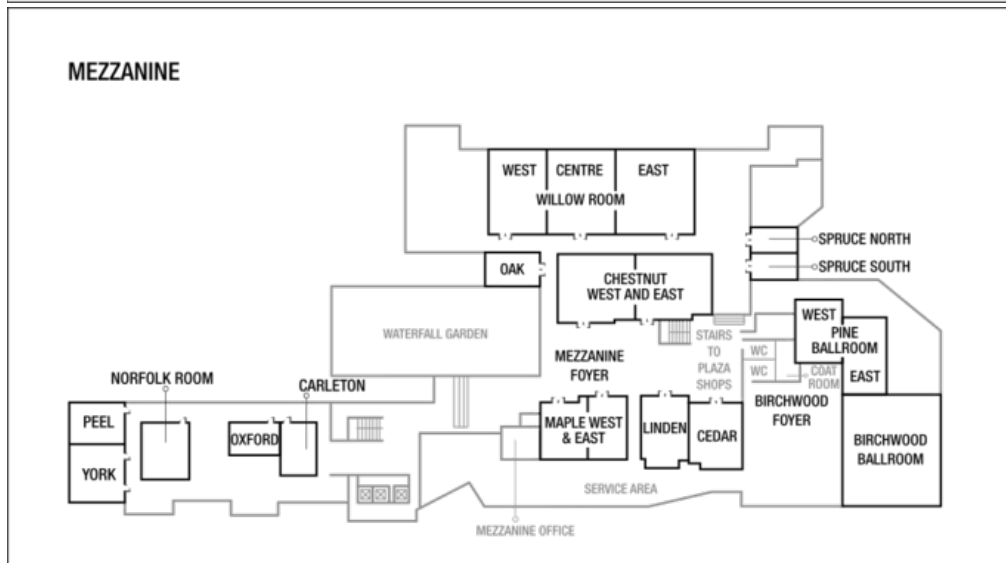
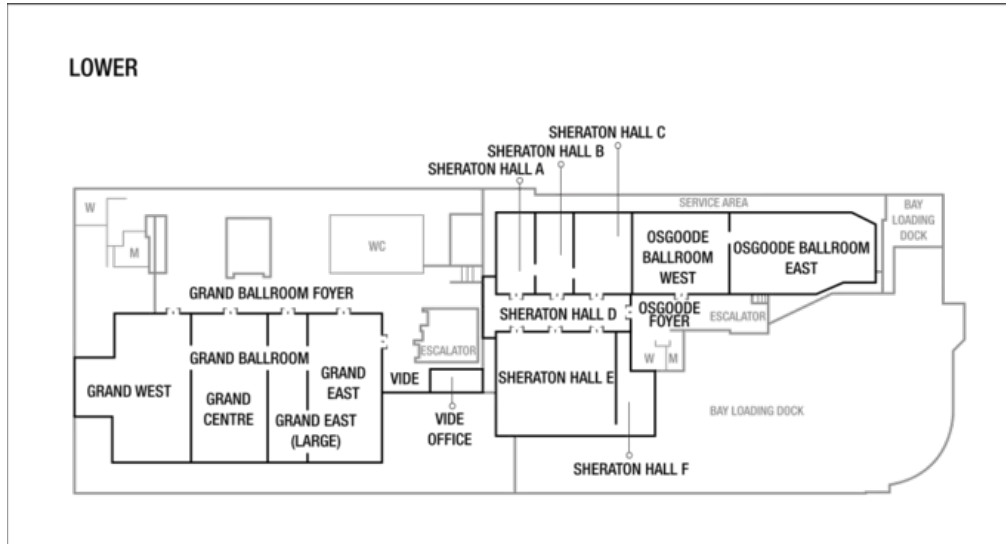



FLOOR PLANS (CONTINUED)

